

HM-SW401S

HDMI 4X1 QUAD MULTI-VIEWER WITH SEAMLESS SWITCHER

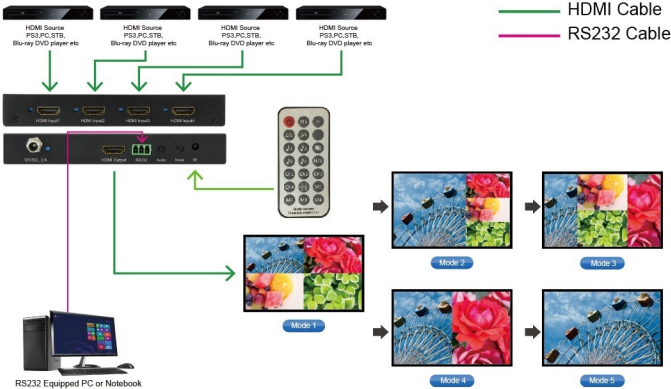

- 4 x HDMI input
- 1080P Full HD
- IR Remote control
- Different display mode
- Button control display mode
- Button control audio input channel



- Mode 1:** The four HDMI input sources are displayed in 2x2 on one screen.
- Mode 2:** The four HDMI input sources are displayed with one bigger and three smaller windows on one screen.
- Mode 3:** The four HDMI input sources are displayed and H-split on one screen.
- Mode 4:** The two HDMI input sources are displayed in 2x1 on one screen.
- Mode 5:** This is the full screen mode, pressing IN1-IN4 button is to select the corresponding channel and displayed in full screen as a seamless switcher.

This HDMI 4X1 Switch is a high performance 4 by 1 Quad Multi-Viewer with seamless switcher. It supports four HDMI input sources to be displayed on one screen with five multiview mode. As a switcher, it can also seamlessly switch the four HDMI input freely. The product can be controlled by various ways, through the front panel button, IR, RS232 control etc.

- Compliant with HDMI 1.3a, HDCP 1.2
- Supports multiplexed HDMI 4-input and 1-output
- Supports up to 1080p60 High Definition resolution
- Support 4 by 1 Quad Multi-viewer and seamless switcher (with same resolution)
- Support button, IR control, RS232 control
- Support scaler up, scaler down function
- Support multi output resolution

PRESENTATION SWITCH HDMI 2.0 4:4:4

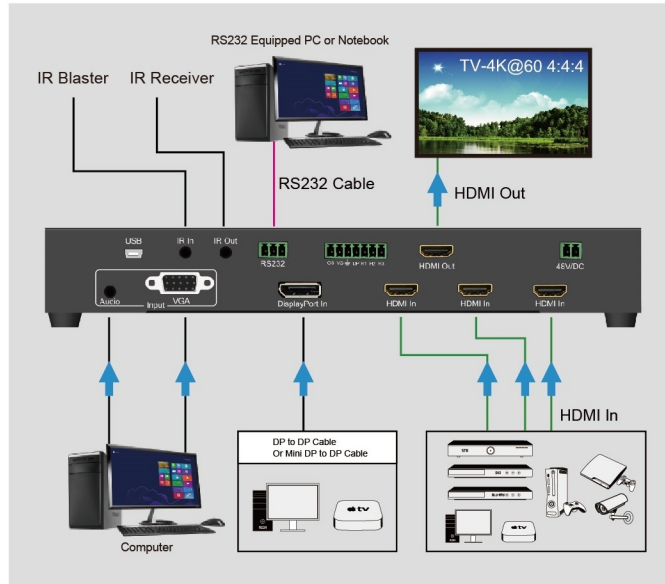

- DisplayPort & VGA Inputs
- HDMI Outputs
- 4K 30 4:4:4, 4K60 4:2:0 (HDMI input Only)
- HDR 4:2:2 12 Bit Support (HDMI input Only)
- HDCP 2.2 & Earlier Supported
- 100M (330ft) On 1080P, Up to 70m (230ft) on 4K (Cat6a) In
- 70M (230ft) On 1080P, 40M (131ft) on 4K (Cat6a) Out
- Fast Switching
- Analog audio extraction
- RS232 & IR Control projectors, AVR's
- Designed for the conference/classroom room so your customer can focus on their meetings, not their video system.

Model	Description
HM-VDH501	5X1 PRESENTATION SWITCH HDMI 2.0 4:4:4
HM-VDH502	MATRIX 5X2 PRESENTATION SWITCH HDMI 2.0 4:4:4

HDMI 2.0 4X4 MATRIX SWITCH 4:4:4

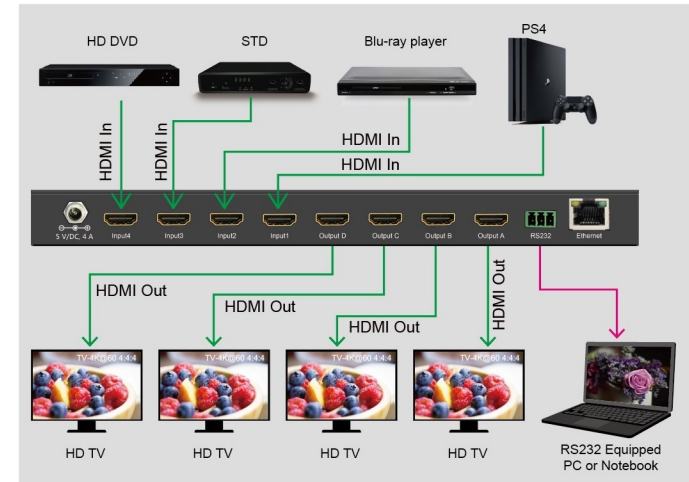
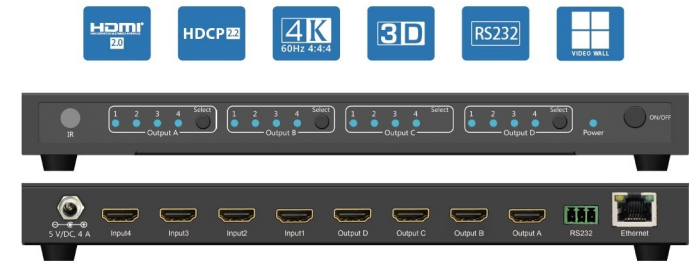

- Digital Distribution: 4 HDMI Source to 4 HDMI Displays
- 4K 30 4:4:4, 4K60 4:2:0 (HDMI input Only)
- HDR 4:2:2 12 Bit Support (HDMI input Only)
- HDCP 2.2 & Earlier Supported
- Fast Switching
- Analog audio extraction
- RS232 & IR Control
- Designed for the conference/classroom room so your customer can focus on their meetings, not their video system.

Model	Description
HM-MT404L	HDMI 2.0 4X4 MATRIX SWITCH 4:4:4 WITH ETHERNET
HM-MT404	HDMI 2.0 4X4 MATRIX SWITCH 4:4:4

INTELLITECH GLOBAL, LLC
 12/4 Koala Town Road, Upper Coomera, QLD,
 4209, Australia
 Website - www.intellitechglobal.com
 Email - sales@intellitechglobal.com

